

NUANCE ANGOLO

forma
aquae

FREEPOSITIONING
BATHTUBS

SCHEDA TECNICA TECHNICAL DATA SHEET

VASCA BATHTUB

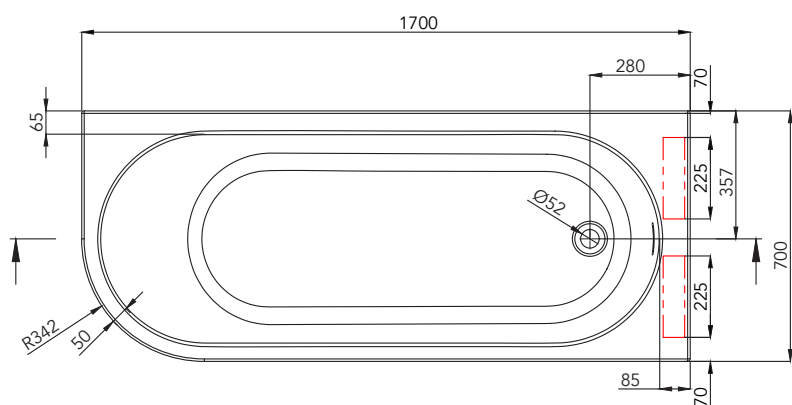
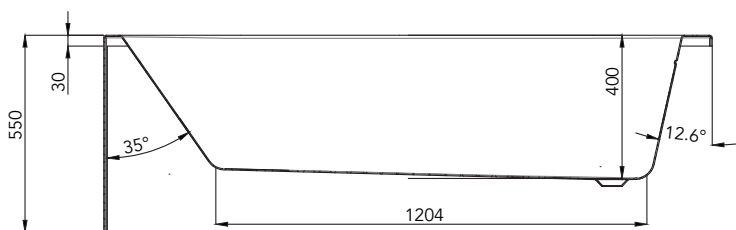

 Posizione rubinetteria/Tap position

 Sifone flessibile/Flexible drain siphon

 Piletta bianca/White plated drain

 Colonna di scarico/Drain column

+/- 5 mm

Materiale / Material	TechFusion
Codici / Codes	VSNAI7070DX; VSNAI7070SX; VSNAI7070DXCOL; VSNAI7070SXCOL; VSNAI7070DX-DCR; VSNAI7070SXDCR; VSNAI7070DXMT; VSNAI7070SXMT; VSNAI7070DXM-TCOL; VSNAI7070SXMTCOL; VSNAI7070DXMTDCR; VSNAI7070SXMTDCR
Colore / Color	Bianco lucido/Glossy white; Bianco opaco/Matt white
Optional	Color System; Decor Dress
Peso netto / Net weight	47 Kg
Peso spedizione / Shipping weight	55 Kg
Dimensioni imballo / Packaging dimension	177 cm x 77 cm x 61 cm
Volume spedizione / Shipping volume	0,83 m ³
Capacità / Capacity	182 Lt
Incluso / Included	Colonna di scarico/Drain column; Sifone flessibile/Flexible drain siphon; Piletta bianca/White plated drain

La ditta produttrice si riserva di apportare le modifiche tecniche opportune al prodotto senza obbligo di preavviso o di sostituzione
The manufacturer reserves the right to make any necessary technical alteration to the products without prior notice or replacement

NUANCE ANGOLO

forma
aquae
FREEPOSITIONING
BATHTUBS

Dati per l'installazione
Installation data

VASCA
BATHTUB

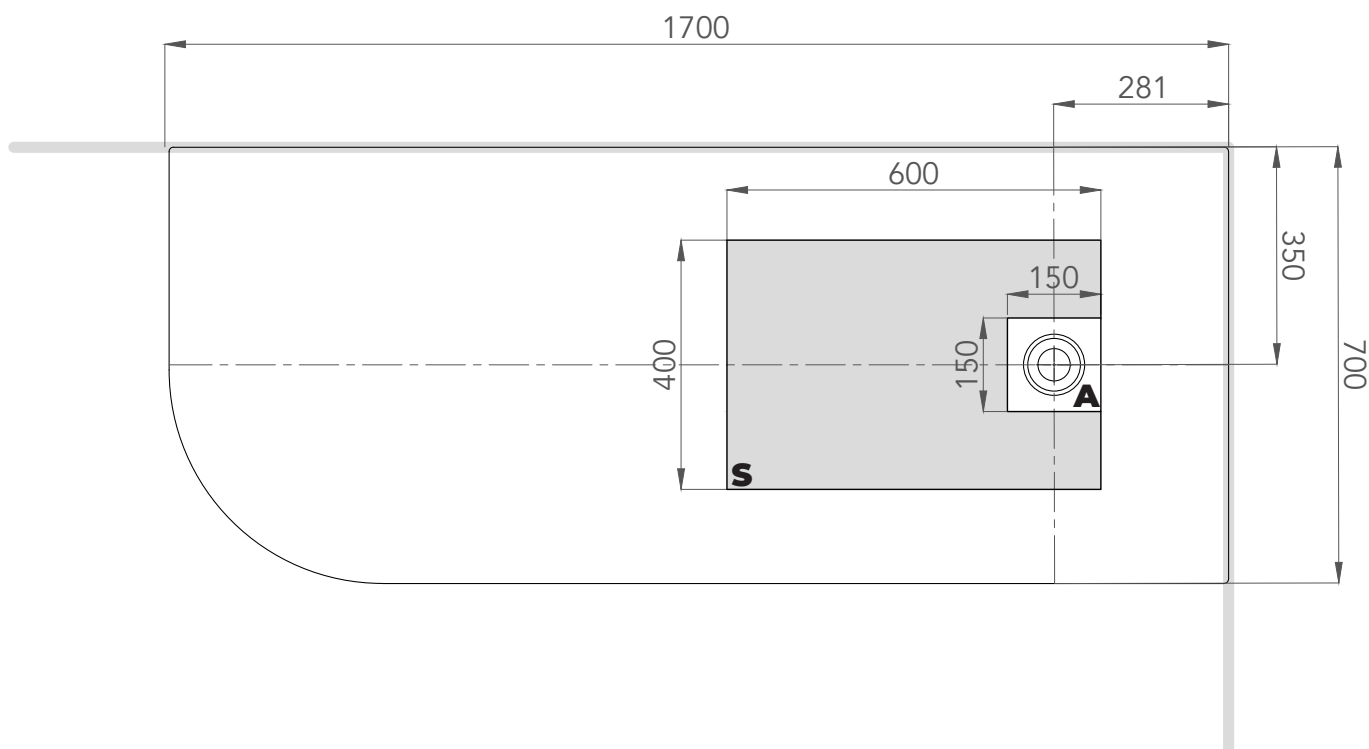

S: Area Scarico

A: Area da non prevedere uscita scarico

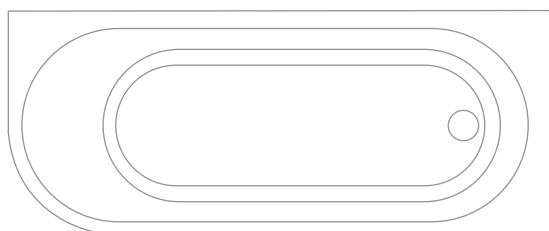

Ad angolo Destro

Right corner

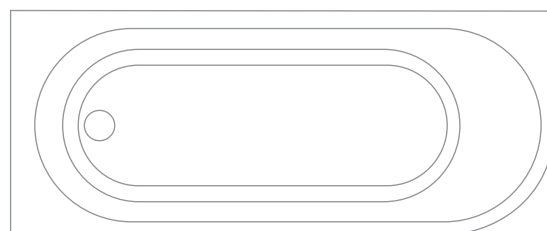

Ad angolo Sinistro

Left corner

La ditta produttrice si riserva di apportare le modifiche tecniche opportune al prodotto senza obbligo di preavviso o di sostituzione
The manufacturer reserves the right to make any necessary technical alteration to the products without prior notice or replacement